

	<p>CITY OF OCEANSIDE Building Division 300 N Coast Highway Oceanside, CA 92054 760-435-3950 www.ci.oceanside.ca.us</p>	<p>Codes 2022 1/1/2023-12/31/25 <i>Effective Date</i></p>
-----------------------------------------------------------------------------------	----------------------------------------------------------------------------------------------------------------------------------------------------------------------------------------------------	---------------------------------------------------------------------

Plot Plan Submittal Requirements

All items listed below must be shown to scale on the Plot Plans. If not shown, your plans will not be accepted.

- Three (3) complete sets of plans. Minimum sheet size 18" X 24". **See plot plan sample on back** →
- Vicinity map
- Indicate job address, owner's name, address, phone number and designer's name, address and phone number.
- Dimensions of all structures from property line and from each other.
- Show the scale used.
- Show the North arrow.
- Plot plans must be clear and legible. Show the **entire parcel** regardless of size and **show all property line dimensions**.
- Show the footprint of all existing and proposed structures to scale, and labeled as either **"Existing"** or **"Proposed"** (do not show **"Future"** structures).
- Identify the use of each structure and include a summary/table of square footages.
- Show site Utilities: Show the location of all existing and proposed electrical services (include service amperage). Indicate the location of the Electrical and Gas meter.
- Indicate the required front, exterior side, interior side, and rear yard setbacks, and building setbacks.
- Show the net area of parcel(s) (exclusive of road easements).
- Indicate Assessor's Parcel number(s) (APN)
- Indicate the driveway(s) and parking areas, paving material and slope of driveway (percentage and direction).
- Show the lot drainage pattern, show the top and toe of any slopes, Show the elevation at the top and the bottom of the slope. Show vertical slope ratio (min 2' horizontal to 1' vertical).
- Show all existing easements, roads, streets, and alleys, including names and width of all easements adjacent to the property, Indicate centerline of all road easements and streets.



CITY OF OCEANSIDE

Building Division
 300 N Coast Highway
 Oceanside, CA 92054
 760-435-3950
www.ci.oceanside.ca.us

Codes 2022

1/1/2023-12/31/25
 Effective Date

Plot Plan Sample

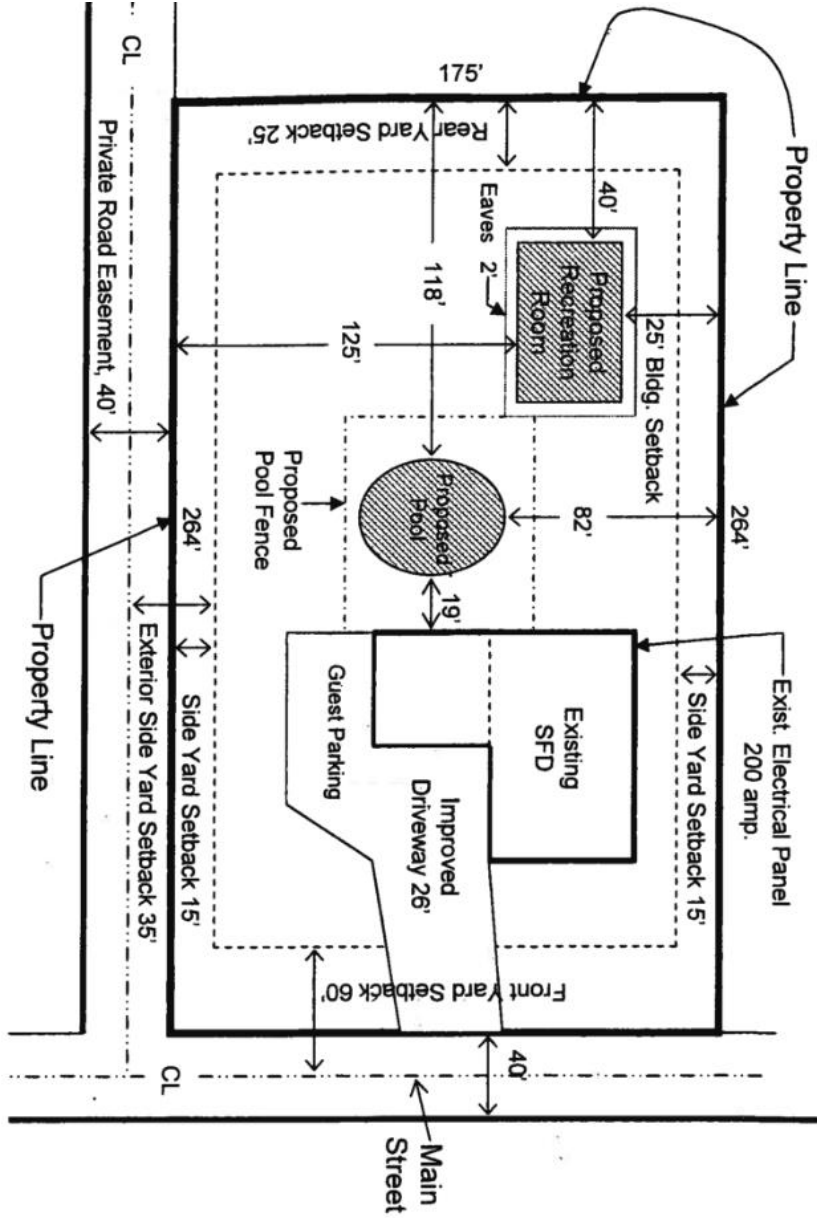

- Existing residence: 2500 sq. ft.
- Attached garage: 800
- Proposed addition: 1200 sq. ft.
- Proposed pool: 850 Sq. ft.
- Total Lot coverage: 5350 sq. ft.
- Lot size: 175' X 264' = 46,200 sq. ft.
- Proposed Lot coverage = (5350 / 46,200) 12%

Owner:
 Carl Sample
 123 Sample Street
 Sample Town, US 90000
 Ph. 700-700-7000

Contact:
 Mike Sample
 124 Sample Street
 Sample Town, US 90000
 Ph. 700-700-8000

Site Address:
 123 Sample Street
 Sample Town, US 90000
 APN# 500-500-50
 2.8 acres (net)

Summary Table

Existing:	Proposed:
SFD, 2,500 sq. ft.	Recreation room, 1,200 sq. ft.
Attached Garage, 800 sq. ft.	Pool 850 sq. ft.

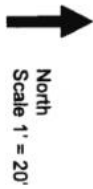

Vicinity Map:

